

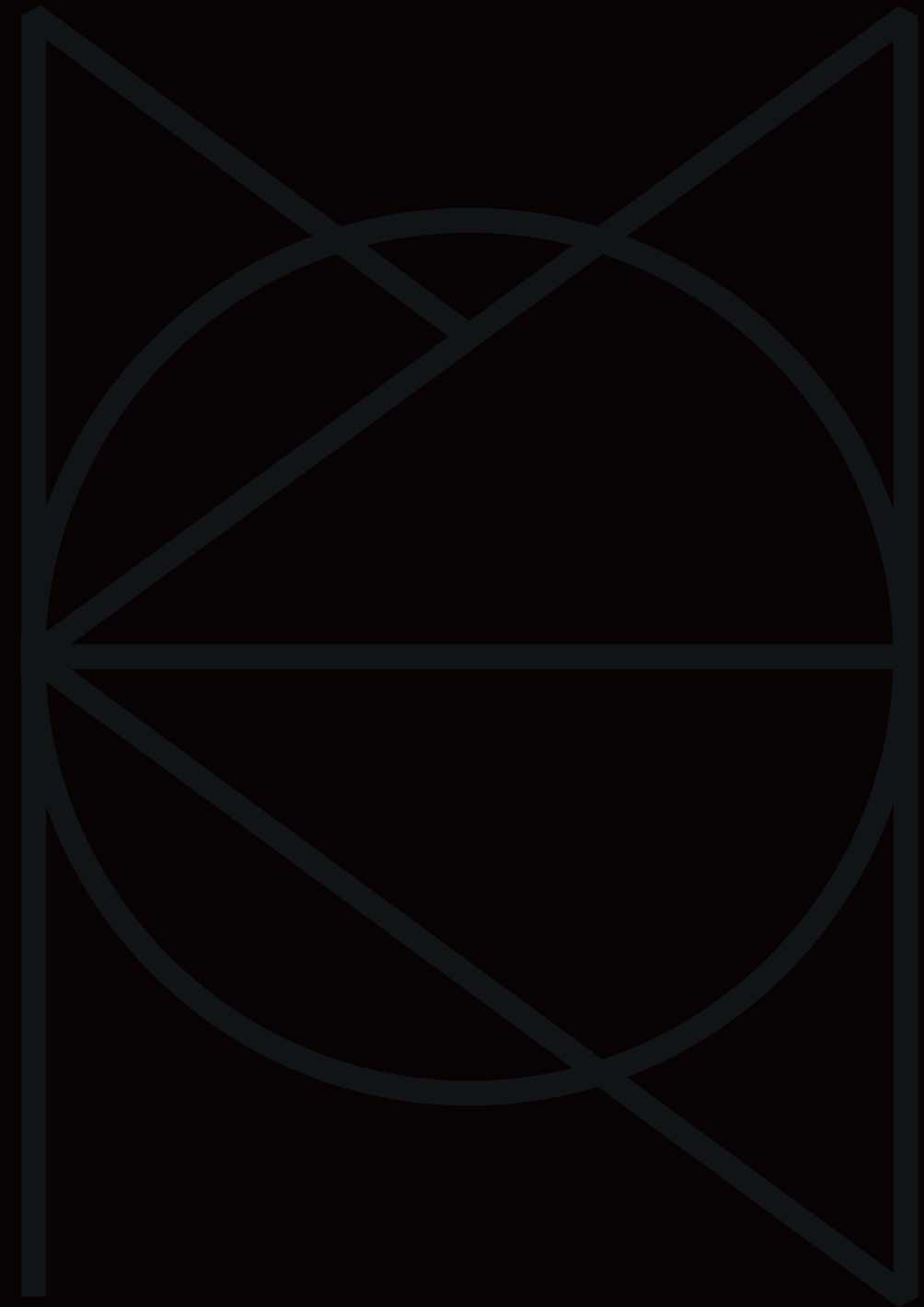

NORTH
KENSINGTON
GATE

G R A N D U N I O N C A N A L



NK G

NORTH KENSINGTON GATE

OLD OAK REGENERATION ZONE

MITRE BRIDGE
GRAND UNION CANAL
LONDON
NW10 6QU

A NEW LANDMARK DEVELOPMENT BY

City 
Docklands

North Kensington Gate will be a landmark residential development that is set to redefine this West London regeneration zone. Located on the Grand Union Canal within the OPDC, this will be one of the most dynamic and best connected new residential districts in the UK.

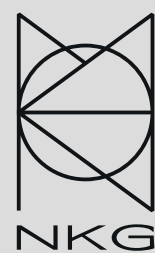

Computer generated image of NKG & Mitre Yard fronting the Grand Union Canal.

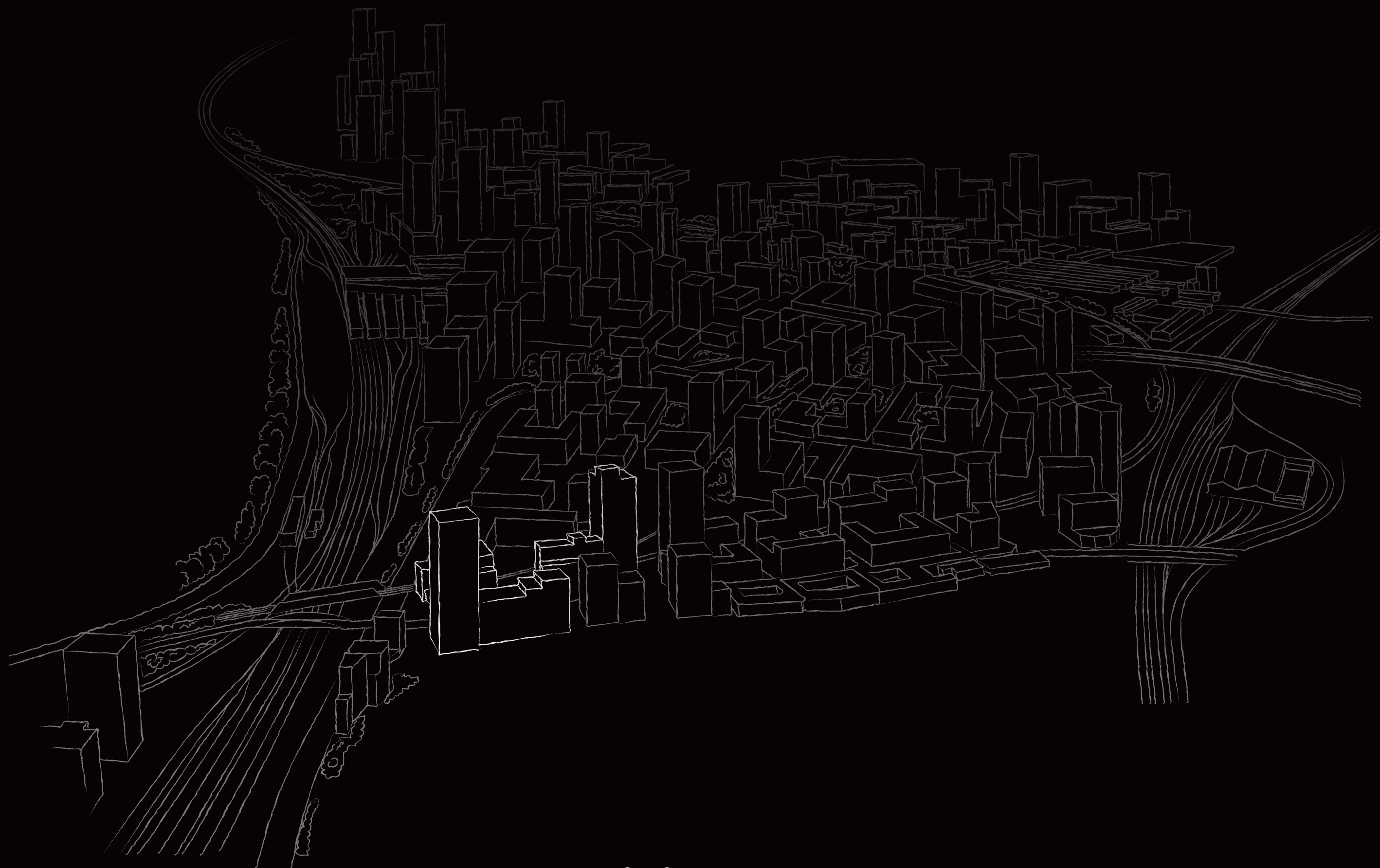

A vision of unparalleled growth

6 MINUTES FROM THE HEART OF THE CAPITAL

NKG will not only offer a unique & luxurious lifestyle opportunity, but will be at the fore front of the transformation of a visionary £26 billion masterplan that will generate a growth zone of unprecedented potential for a decade to come.



North Kensington Gate will rise 24 levels to provide **a unique soaring statement** at the very entrance to West London's most futuristic new district.

The development will offer **150 luxurious private apartments** amid an array of ground level and elevated landscaped gardens.

Computer generated image of NKG tower and roof garden.



- NKG comprises 150 highly specified executive suites, 1, 2 & 3 bedroom apartments, each with a private balcony or sun terrace.
- The development will be mixed use including extensive co-working space.
- Residents will enter via an opulent reception foyer with concierge desk, the ground level will also feature a private garden lounge overlooking landscaped courtyards.
- NKG will be situated immediately adjacent to Mitre Yard - City & Docklands PRS showcase development.
- Mitre Yard will provide fabulous lifestyle facilities including The Seacole Brew House - a themed lounge bar and restaurant fronting the Grand Union Canal.
- Residents at NKG will be a 1 minute walk from the amenities Mitre Yard will offer, including art studios and designer workshops.

Placemaking. Where architecture meets art

DEVELOPMENT OVERVIEW

- NKG will be little over a 10 minute walk from tube and overground services at Willesden Junction.
- Old Oak Common, the forthcoming HS2 and Crossrail super-hub will also be within convenient walking proximity.
- The development will lie immediately adjacent to the Grand Union Canal with its tow path providing a tranquil 20 minute cycle route to Paddington.
- The OPDC's vision for the regeneration of the Mitre Bridge area is to provide a new futuristically designed pedestrian truss bridge spanning the canal and rail lines connecting to the opposite tow path and route towards White City.



SEACOLE BREW

ERINS MOSA VOYAGE	4.5%	£5.20	WHITE RIOT	5.0%	£5.20	ERINS MOSA VOYAGE	4.5%	£5.20
BREAKFAST STOUT	5.5%	£5.20	ALL DAY PALE ALE	2.7%	£4.50	BREAKFAST STOUT	5.5%	£5.20
DIPA	7.5%	£4.50	TREASON	5.8%	£5.45	DIPA	7.5%	£4.50
	8.5%	£4.50	BA WASTELAND	10%	£3.50		8.5%	£4.50

SEACOLE
BREW HOUSE

A world of distinct, urban elegance

BEAUTIFUL LOUNGE BAR, ARTISAN STUDIOS & A HOST OF AMENITIES
1 MINUTE FROM YOUR APARTMENT AT NKG





As the shift of the Capital's focus grows and expands to the west, the momentum of change is ever more dramatic. White City is today, the Capital's leading academic, cultural and retail quarter, Old Oak Common Interchange is under construction and Old Oak itself is seeing inward investment on a scale comparable to Canary Wharf in the early 90's. Major development to the east of NKG is also endorsing the district as a high end, sought after location for luxury London living. NKG is instrumental in the change, a vital part of the catalyst as West London takes centre stage.

West London takes centre stage

CHANGING THE CAPITAL'S LANDSCAPE





The Grand Union Canal provides an idyllic towpath route to the heart of Paddington - being just 20 minutes cycle time from North Kensington Gate.



The locality today

FROM QUIET WATERWAYS TO COCKTAIL BARS, SPEAKEASIES, SUPPER CLUBS, BUSTLING MARKETS & MORE



One of London's most affluent & culturally energetic districts on your doorstep

THE ROYAL BOROUGH OF KENSINGTON & CHELSEA

The western boundary of London's most celebrated royal borough lies at Mitre Bridge - literally, a stone's throw from North Kensington Gate.

This niche pocket of the Capital is home to many world renowned landmarks including Harrods, Harvey Nichols, Portobello Road Market, the Notting Hill Carnival, Victoria & Albert Museum, Kensington Palace, the Grand Union Canal itself together with a plethora of 'A-List' gastro haunts, bars, clubs and hotels.

Today, the streets of Notting Hill are as much about celebrity clientele as they are it's iconic painted townhouses and terraces.

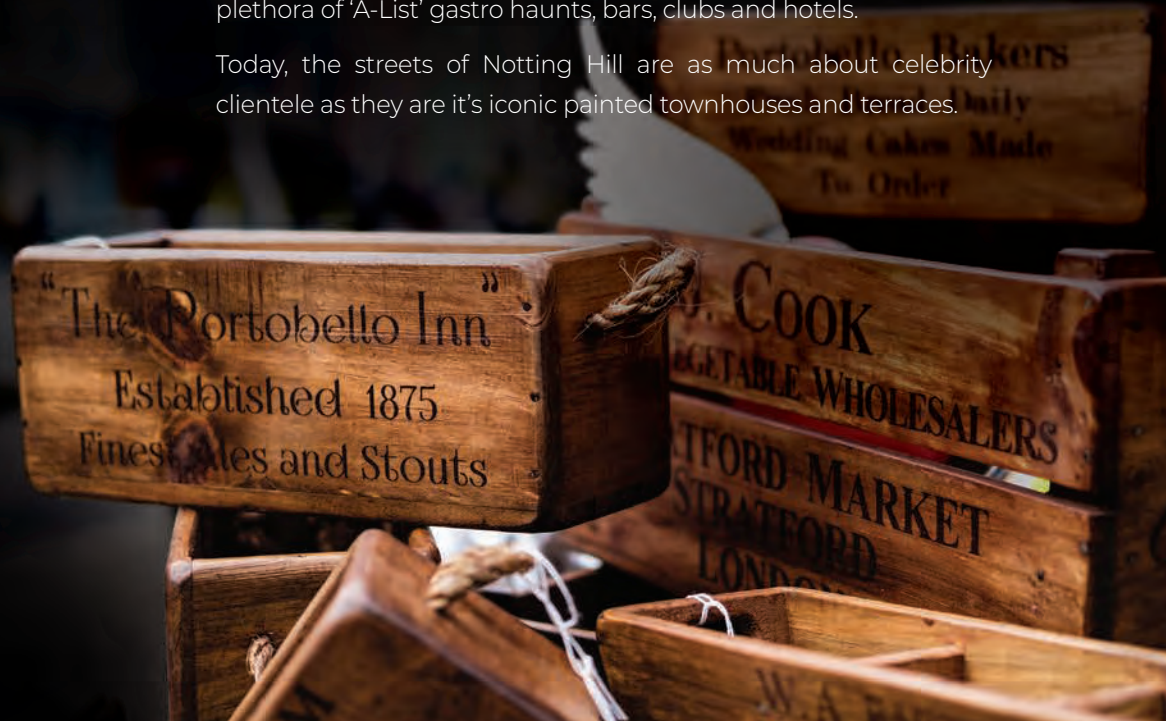

Willesden Junction - served by the Bakerloo Line and Overground will be little over 10 minutes walk from NKG.



From a vision to vivid reality

THE TRANSFORMATION
HAS BEGUN



Computer generated image.



Curzon Street Station
BIRMINGHAM

The forthcoming HS2 high speed rail link will have two major new hubs, Old Oak Common - the £1.7 billion interchange that will be the largest new build station ever constructed in the UK, together with Curzon Street Station - a brand new £570 million intercity terminus forming the focal point of Birmingham's Curzon Street masterplan. Both stations are scheduled to be operational by 2026.

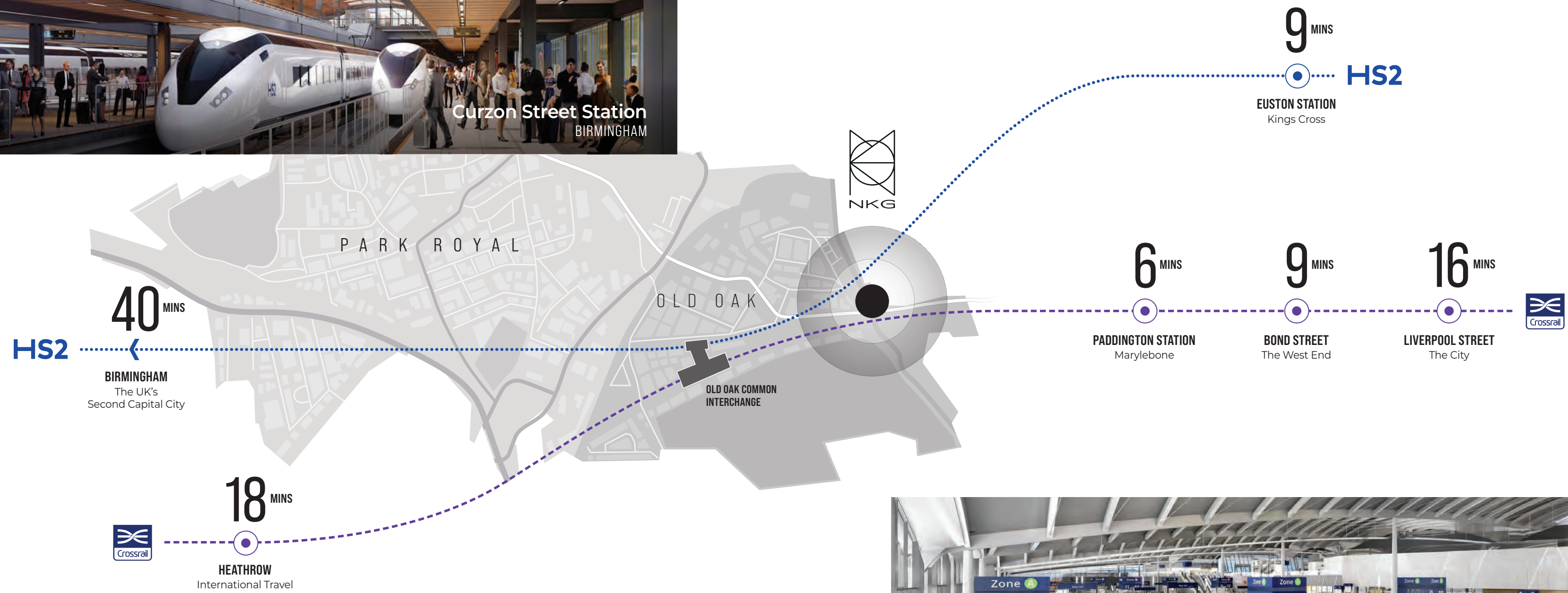

Residents at NKG will be minutes from unrivalled connectivity

WITH OLD OAK COMMON PROVIDING THE ONLY RAIL SUPER-HUB ON THE NEW HS2 NETWORK TO BE SERVED BY CROSSRAIL



Old Oak Common
WEST LONDON



North Acton

Old Oak Common Lane

HS2 Old Oak Common

Grand Union Park

Willesden Junction



A masterplan to deliver a thriving new world class district & destination

FUELLED BY THE MOST TECHNOLOGICALLY ADVANCED TRANSPORT INFRASTRUCTURE IN THE UK

Old Oak Common Interchange and the surrounding transport network are projected to extend the catchment area for new commercial sectors bringing 250,000 additional people and 150,000 additional jobs to within a one hour commute. The district's commerce is projected to fuel the UK economy by £7.6 billion a year.

This inspirational vista of new era urban excellence will be a 5 minute canal-side stroll from the apartments at NKG



Grand Union Park in the heart of Old Oak



- A comprehensive road, rail and air travel transport infrastructure is already in place.
- HS2 will deliver a new £1.7 billion super hub high speed interchange in the heart of the district.
- 7 rail and tube lines will interconnect across the area.
- Park Royal is already recognised as Europe's prime manufacturing and logistics based district.
- London's population is projected to grow to around 11 million by 2050 - residential and commercial growth can only greatly expand to the west.
- West London is already seeing unprecedented inward investment with the expansion of Westfield and Imperial College London at White City.
- The new visionary district will provide up to 25,000 new homes and some 65,000 new jobs.

The dynamics that will deliver a brand new £26 billion district

OLD OAK & PARK ROYAL - THE FACTS

- The district's commerce is projected to fuel the UK economy by £7.6 billion a year.
- Imperial College London have expanded their campus facilities at Portal Way with two major new residences (30,000 sq.m) in addition to their existing 690 unit Woodward building.
- Imperial College London are also initiating a £1 billion 4.5 acre masterplan to fully transform 1 Portal Way into a vibrant new space with a phased delivery of some 1,500 new homes, co-living units, retail, restaurants, a 70,000 sq.ft hotel and 180,00 sq.ft of offices and co-working space.
- Ballymore are in partnership with Sainsburys to create a £1.7 billion canalside town centre to the east of NKG - developing within the Kensal Canalside Opportunity Area.
- NKG is City & Docklands third major residential development within the OPDC Regeneration Zone - collectively delivering 1,150 new apartments.

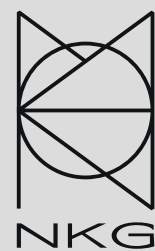

The immediate vicinity surrounding NKG on Scrub's Lane has a vision to include:

- New open space and public realm.
- 5 pockets of designated town centre environs.
- A vibrant mix of social lifestyle & recreational amenities.
- Increased and new bus routes & services.
- New walking and cycling routes.
- A potential new futuristic pedestrian truss bridge.
- Nearby educational and health facilities.
- New canalside gardens and lounge bar themed by the late Mary Seacole (inspirational british nurse 1805-1881).



Computer generated image.

Old Oak Common

The super-hub in numbers:

4

CROSSRAIL
PLATFORMS

6

SUB SURFACE
HS2
PLATFORMS

10

MINUTE
SERVICES TO THE
WEST END

14

PASSENGER
PLATFORMS
IN TOTAL

18

MINUTE SERVICES TO
LONDON HEATHROW

53

MULTI LEVEL
PASSENGER
LIFTS

1,300

SQUARE METRES OF
GLASS WITHIN THE
CONSTRUCTION

2,300

JOB SUPPORTED
DURING THE BUILD
PROGRAMME

250,000

PASSENGERS EXPECTED TO PASS
THROUGH THE STATION DAILY

Above all, one single interchange projected to contribute to a £15 billion boost to the economy over the next 30 years.



Computer generated image.

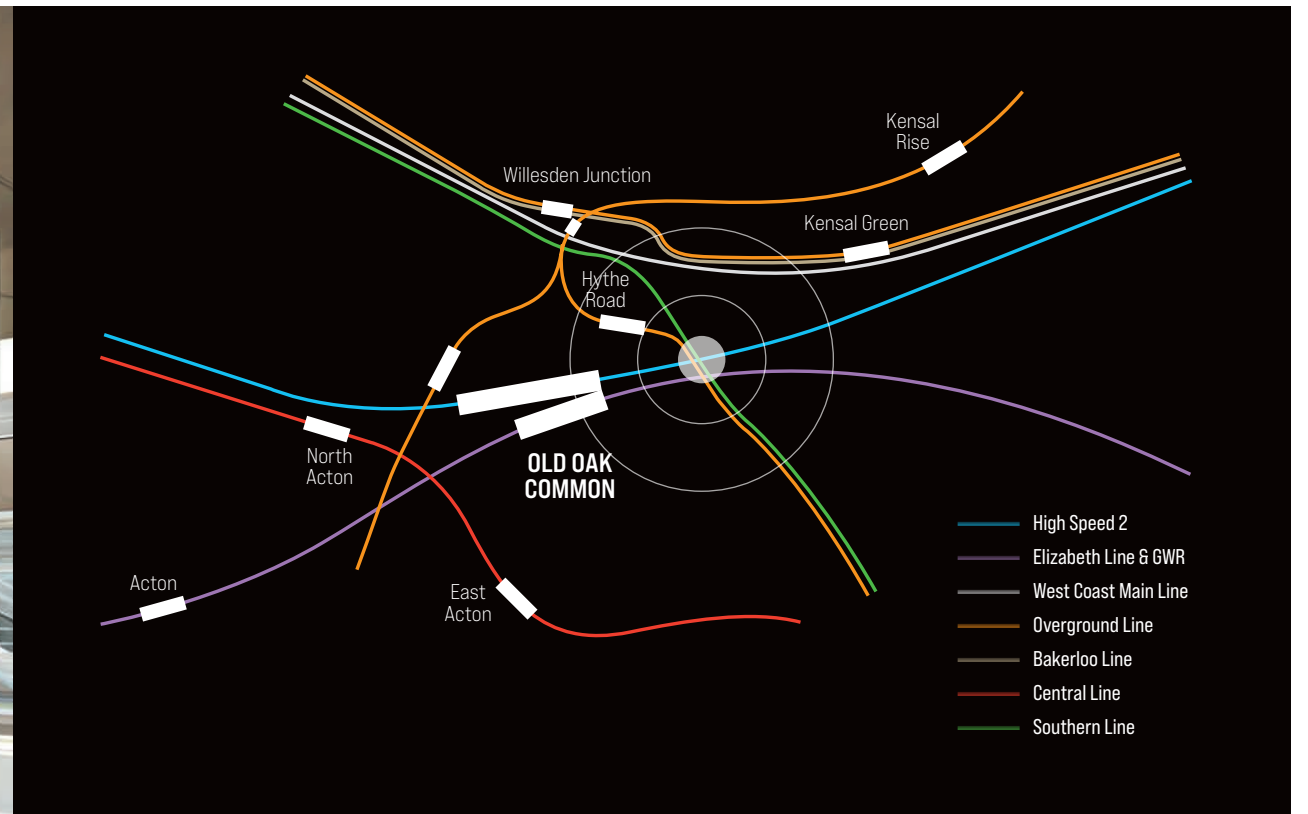

The central location of NKG will provide unprecedented access to 7 rail and tube lines

TOGETHER CONNECTING TO NOT ONLY LONDON'S BUT THE UK'S ENTIRE TRANSPORT NETWORK



When delivered, Old Oak Common super-hub will have 14 platforms - with six being built underground to serve the HS2 line, this engineering feat will define it as one of the largest subterranean structures in the world. An overbridge will link to the station's ground level platforms which will be served by the Elizabeth line. The entire station will be encompassed by a vast roof, with its design inspired by the site's industrial heritage.

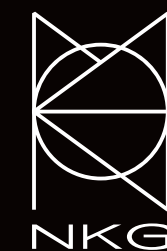



Soho House

Imperial College London

WHITE CITY PLACE

BBC

itv

RALPH & RUSSO

YOOX NET-A-PORTER GROUP

Royal College of Art

TELEVISION CENTRE

Westfield

White City



LITTLE OVER 15 MINUTES WALK INTO A WORLD OF CULTURAL, COMMERCIAL & ACADEMIC EXCELLENCE

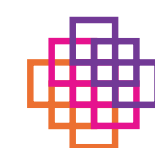

INNOVATION ACADEMIA FASHION CREATIVITY LEISURE

TECH MULTI MEDIA

Imperial College London

Encompassing 10 hectares, ICL's White City Campus has seen £2 billion in investment and continues to expand its world leading research.

WHITE CITY PLACE

Now a thriving 17 acre business district and where some 3,000 BBC staff continue creative production. It is also home to The Royal College of Art.

TELEVISION CENTRE

A mini metropolis in itself and home to White City House with its fabulous 45 room deluxe hotel with private members club and rooftop pool.

Westfield

Westfield London remains Europe's largest shopping centre with over 300 stores, 700 brands, 70 places to eat and a 20 screen Vue Cinema.



NORTH KENSINGTON GATE TO WHITE CITY



3

MINUTES



5

MINUTES



16

MINUTES

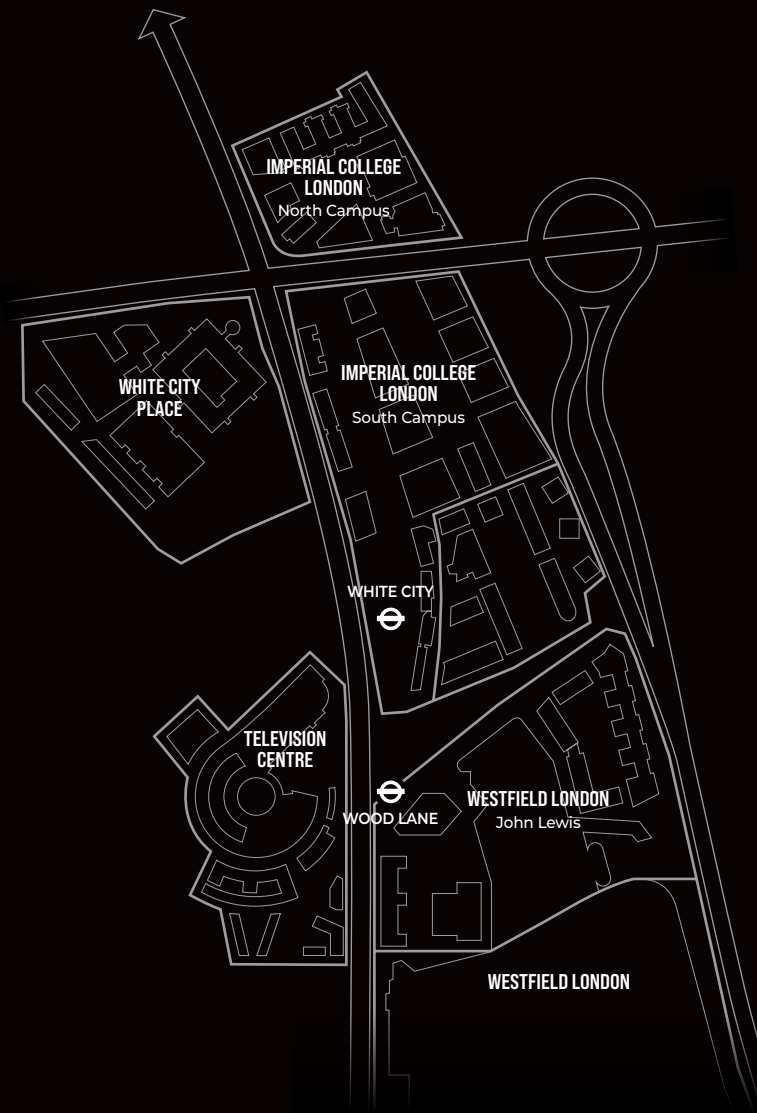

White City

Dynamic by design

Today, White City is an exemplar of 21st century architecture creating a fusion of visually striking landmark buildings that so define it as a leading, state of the art district.

- Imperial College London has around 19,000 students including 10,000 undergraduates across its campuses.
- Student nationality remains predominantly from outside the UK (64%) with 21% from China and the Far East.
- Academic staff total in excess of 4,300 with 1,300 scientists, clinicians and engineers now located at White City.
- ICL works with more than 500 corporate partners helping turn cutting-edge scientific research into real world benefits for society.
- Over 6,700 degrees are awarded by ICL every year.
- Imperial is home to the greatest concentration of high-impact research, with a framework ahead of any other major UK university.

Data: 2018 - 2020

A global top 10 university minutes from NKG

IMPERIAL COLLEGE LONDON

ICL's vast 23 acre campus complex lies within one mile of NKG (around 15 minutes walk). It is the only university in the UK entirely focussed on science, engineering, medicine and business. The university maintains its reputation for excellence in teaching and research - which consistently ranks it in the top 10 universities worldwide.

 **ICL is ranked
2nd in London
and 7th in the
world 2021**

Source: The Guardian University Guide 2021
& QS World University Rankings 2022

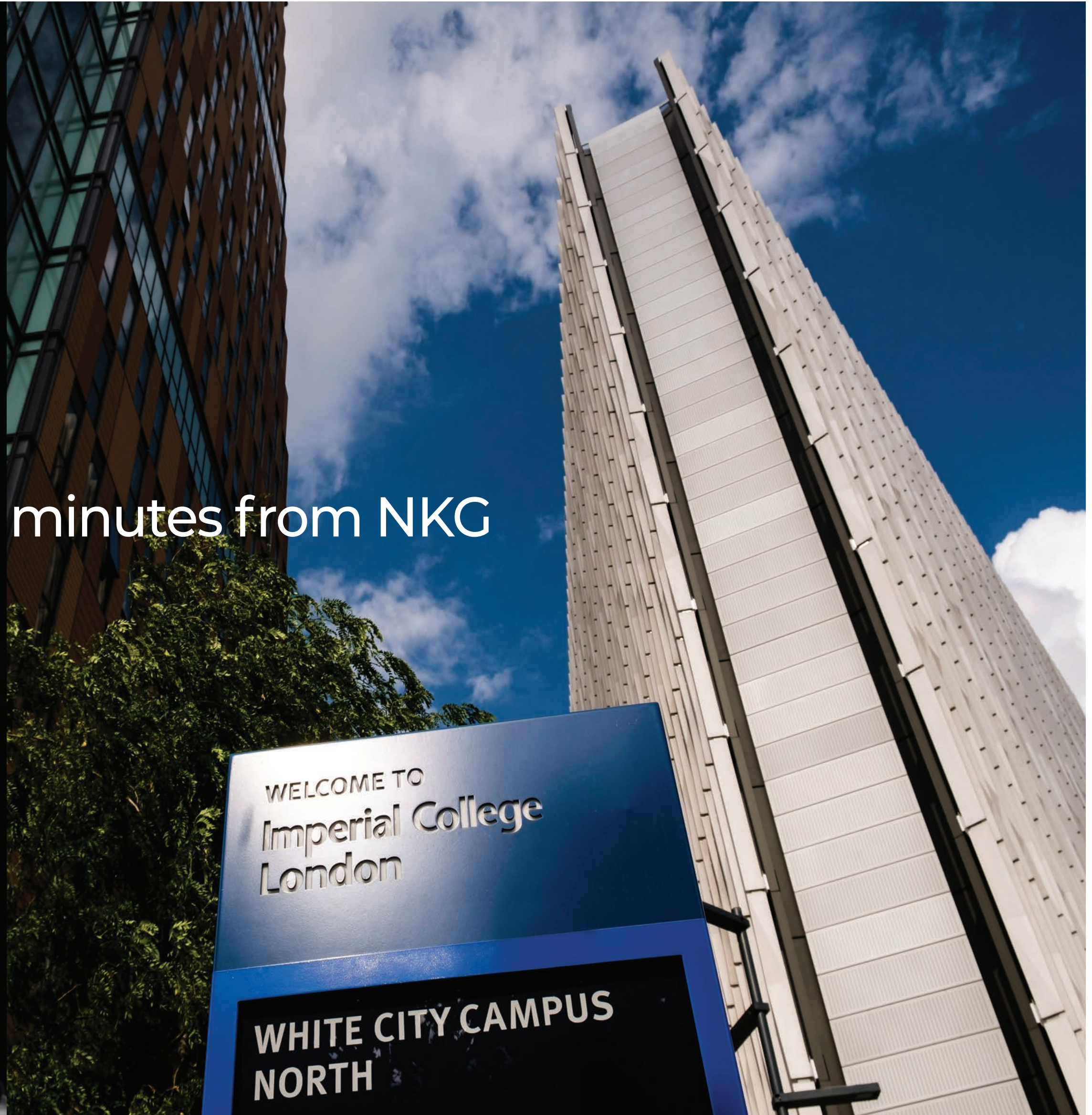



With over 680 luxury retail and fashion stores alone, this spectacular shopping & leisure showcase will be deceptively close to the apartments at NKC.



Westfield
LONDON



CREATIVE WORKSHOPS GALLERIES BREW HOUSE CANAL & ROOF GARDENS

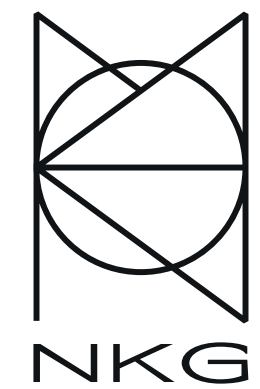

NORTH KENSINGTON GATE & MITRE YARD

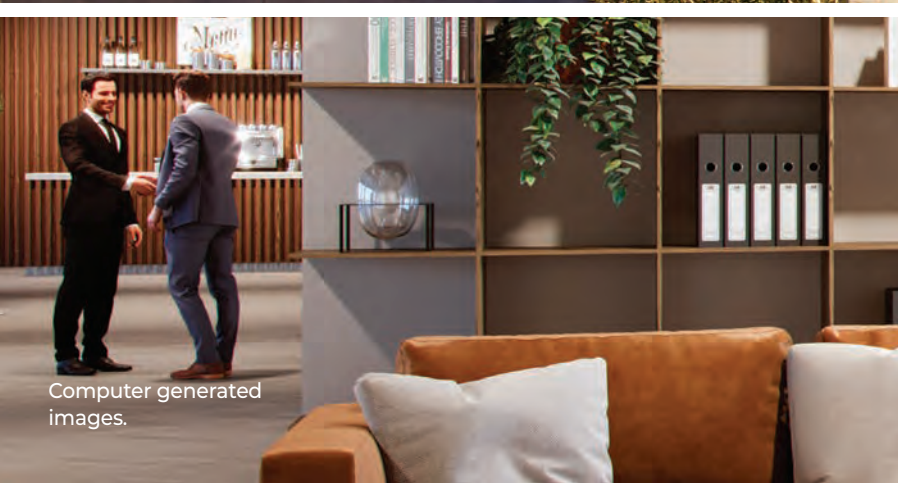

Computer generated images.



Computer generated image.

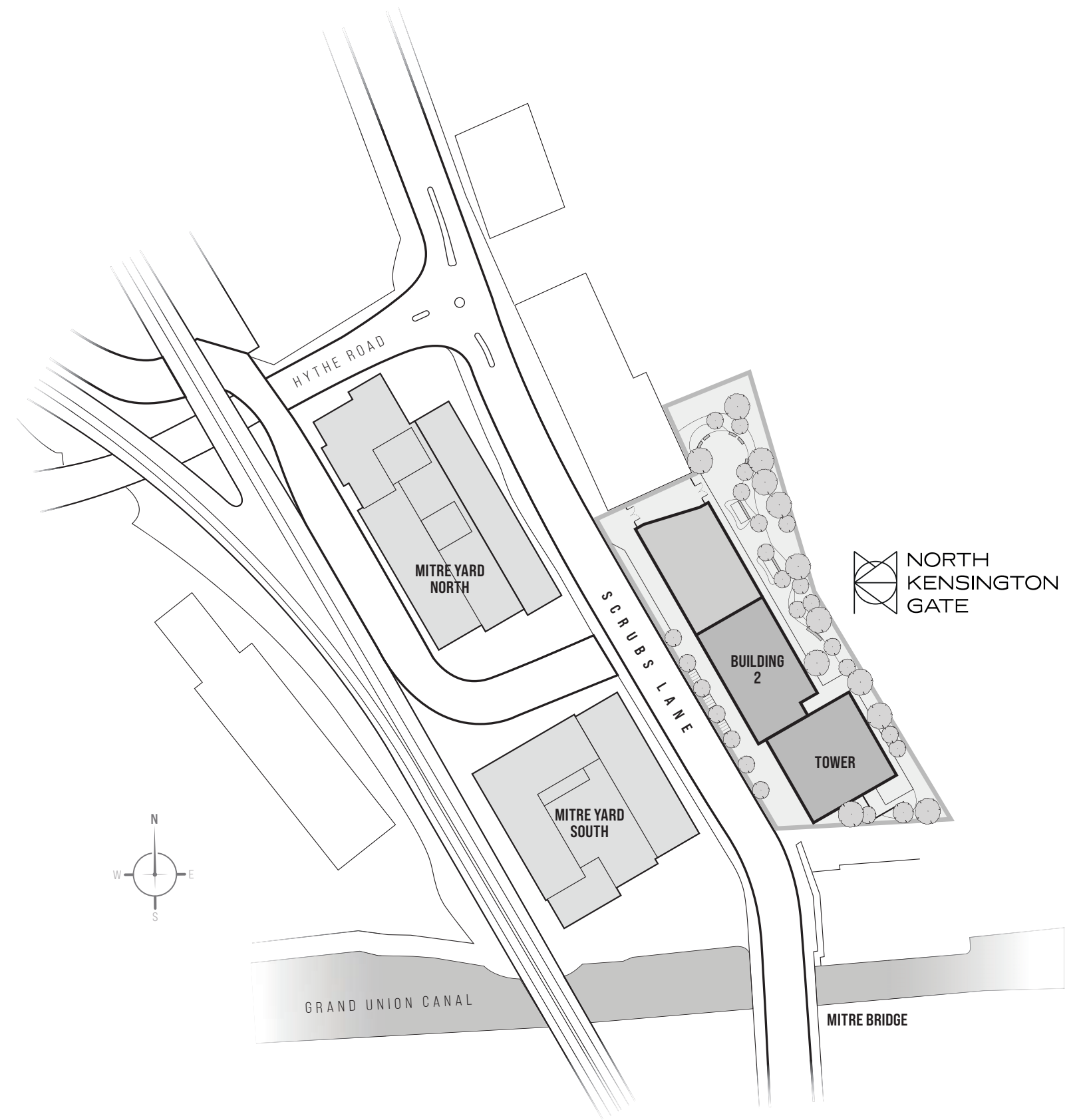

North Kensington Gate & Mitre Yard will together, provide a superb array of upscale lifestyle facilities



Computer generated image.

Seacole Brew House & garden terrace located in Mitre Yard

The establishment & gardens are themed after the distinguished British - Jamaican nurse, Mary Seacole (1805-1881).



Computer generated images of how studio/gallery spaces may look.

Space and the place for artists, makers, designers and creatives

Mitre Yard will offer a cluster of creative workspace designed as incubator units for emerging practices up to showcase galleries for established studios.

This artistic hub will be a 1 minute stroll from your luxury apartment at NKG.



NKG will be a melting pot for entrepreneurial productivity & business growth - stimulated by a brand new co-working community



Computer generated image of NKG co-working space, interior design detailing may vary.



46 Computer generated image of NKG reception foyer, interior design detailing may vary.

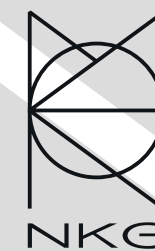
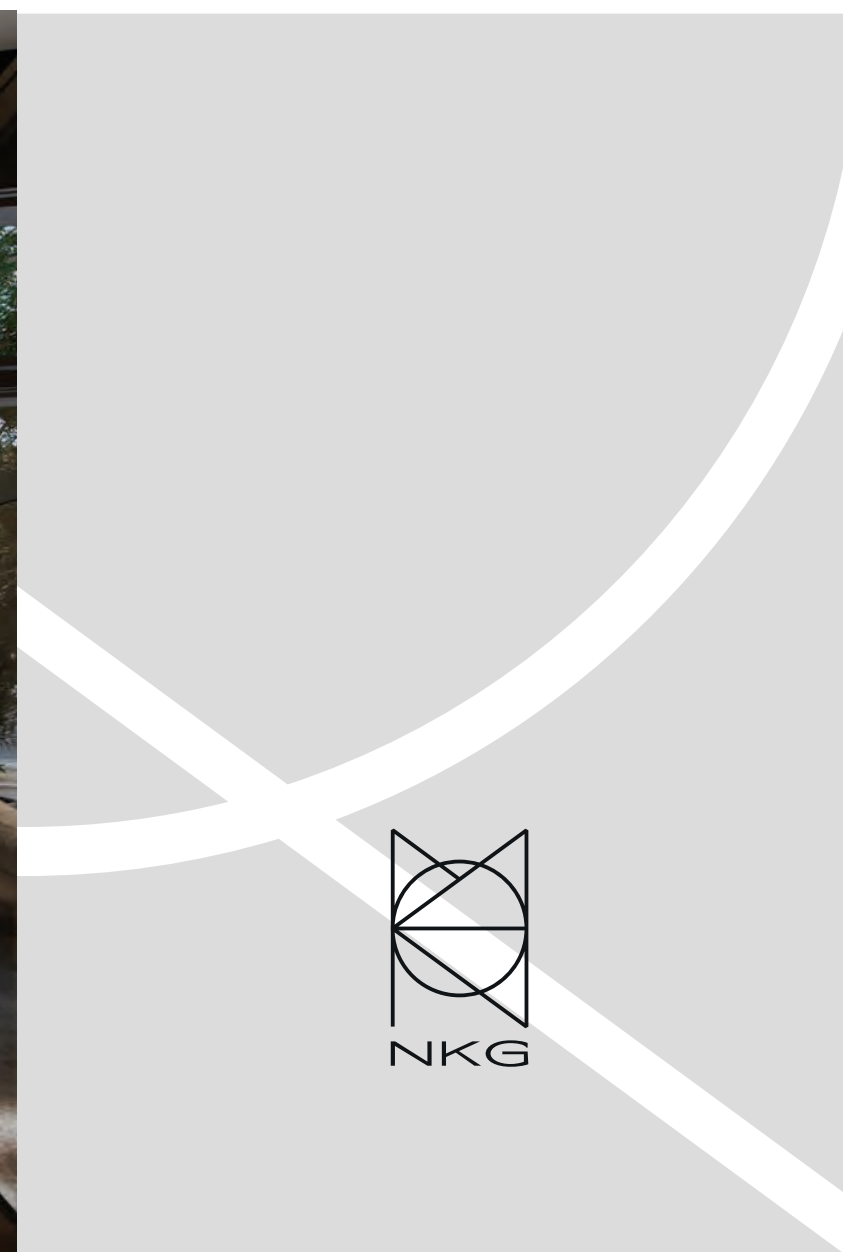

Residents will enter NKG Tower via an opulent reception foyer with concierge desk and services



The apartments

STYLE BEYOND INSPIRATION



Whatever your choice
of apartment style, each will be alive with
sophisticated urban elegance

Computer generated image, interior design and finishes
shown are conceptual only, materials, finishes and fittings may vary.



Sleek,
functional and
inviting space
for high end
London living

Intelligent space

Computer generated image, interior design and finishes shown are conceptual only, materials, finishes and fittings may vary.



Each apartment at NKG will have a private balcony or dual aspect terrace



Computer generated image, interior design and finishes shown are conceptual only, materials, finishes and fittings may vary.



Interior decor will be specified to include a stylish palate of warm tone hues. Principal living areas and bedrooms will have light coloured composite strip flooring. Bathrooms will feature ceramic marble style floor and wall tiling.

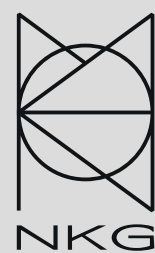

Computer generated images, interior design and finishes shown are conceptual only, materials, finishes and fittings may vary.



Computer generated image, interior design and finishes shown are conceptual only, materials, finishes and fittings may vary.



Specifications & interior finishes

GENERAL

- High quality solid core veneered flush front door.
- Bespoke solid core internal doors with refined contemporary door furniture.
- All with private balcony or terrace.
- Feature architrave and skirting.
- Timber style flooring to living room, kitchen area, hallway and bedrooms.
- Underfloor heating.

ELECTRICAL

- High specification down lighting.
- Mood lighting to living room and each bedroom.
- Brushed steel switch and socket plates.
- Telephone and home network points to living room and bedrooms.
- Sky Q satellite connections to living room and bedrooms (subject to subscription).

BEDROOMS

- Each will be highly specified to include full height wardrobes with mirror fronted doors.

BATHROOMS

- White bathroom suite featuring shower tray or bath as appropriate, floor mounted wc, glass shower screen and chrome fittings.
- Heated towel rail.

- Ceramic floor tiling and full height wall tiling to bathrooms, en-suite and shower rooms.
- High quality vanity unit with mirrored cabinet.

KITCHENS

- Exclusive custom design with granite worktop.
- Smeg (or similar prestige brand) integrated appliances to include:
 - Oven with touch sensitive ceramic hob, extractor hood.
 - Fridge/freezer, dishwasher and combination microwave.
 - Integrated or freestanding (cupboard) washer/dryer.
- Wall unit underlighting.
- Timber style flooring.

FIRE SAFETY

- Integrated sprinkler system throughout.
- Mains operated smoke detectors to apartment hallways and communal areas.

SECURITY

- Video security entry phone connected to concierge.
- CCTV security to car park, entrance lobby and communal grounds.
- 24 hour concierge and services.

Many apartments will enjoy
unrestricted panoramic views of the
Capital's skyline

Actual view from upper level Tower apartments looking south east



Actual view from upper level Tower apartments looking north east



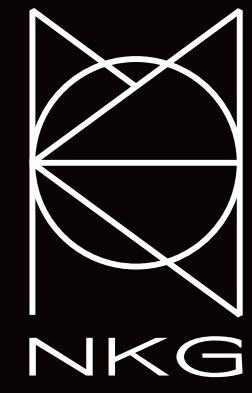

NORTH KENSINGTON GATE

FLOOR PLANS

NKG offers innovation at every level - with 24 floors offering a superb choice of spaciouly designed apartment types, each with private exterior space together with a vast communal roof garden at level 8, the development excels in perfectly proportioned living space - with apartment types ranging from around 432 sq ft to over 1340 sq ft.

The development

APARTMENT TYPE OVERVIEW

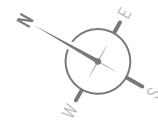
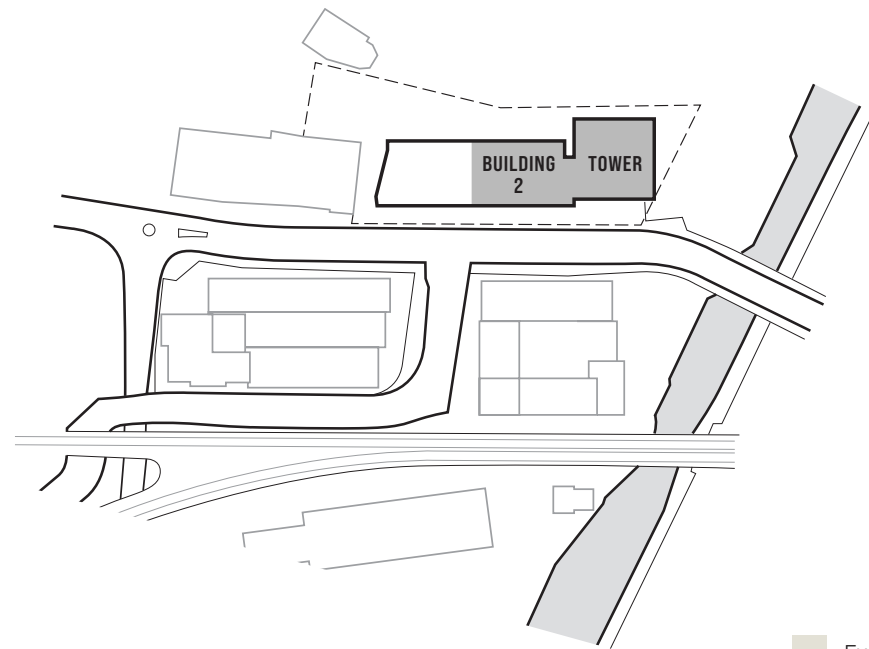

- Executive Suites
- 1 Bedroom
- 2 Bedroom
- 3 Bedroom

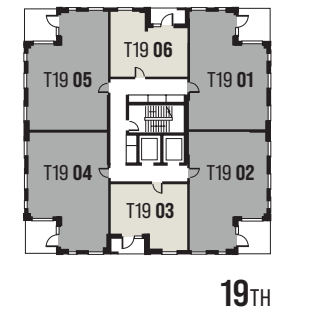
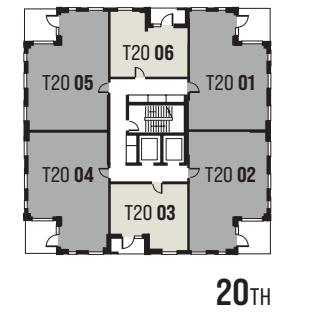
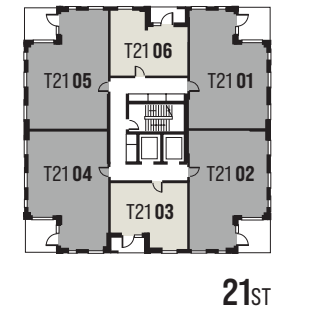
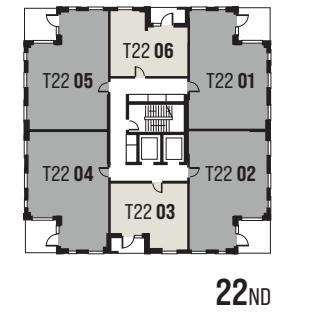
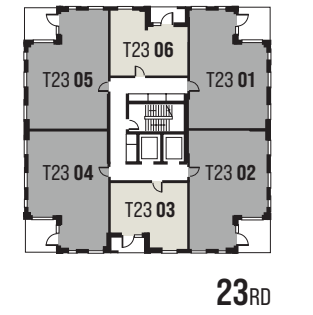
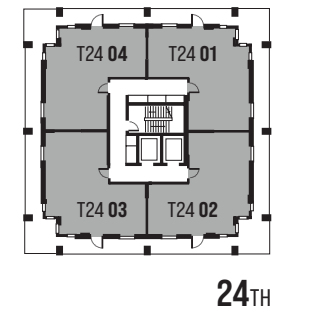
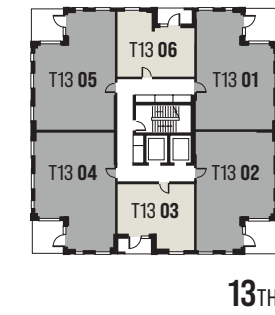
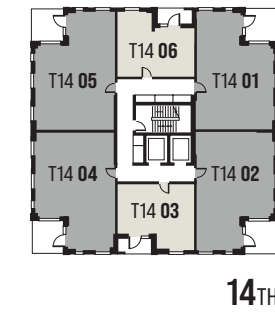
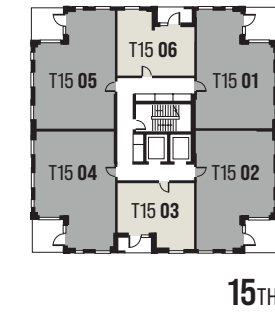
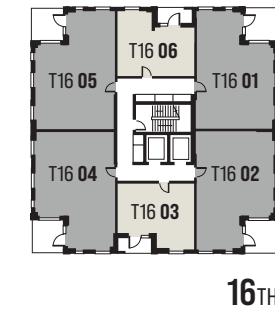
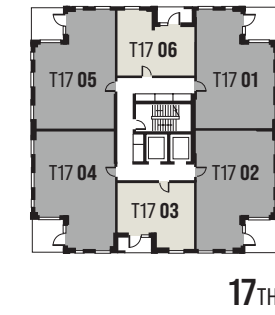
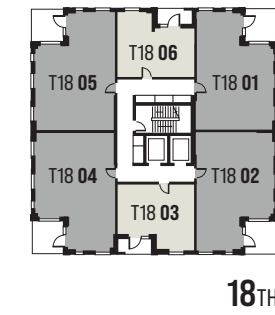
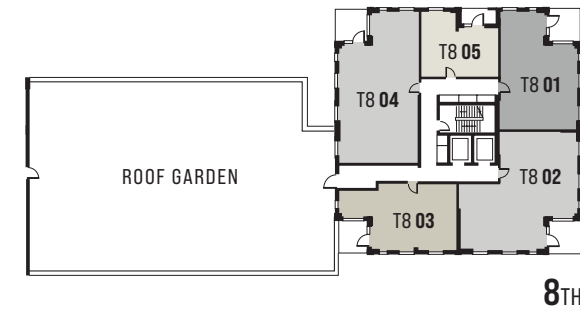
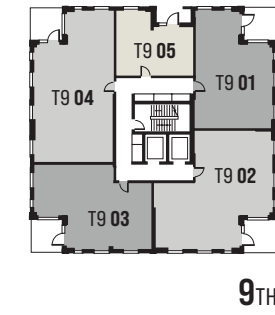
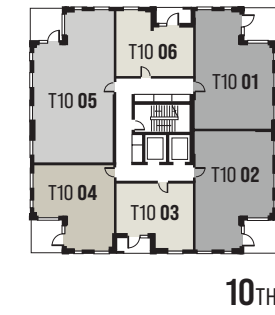
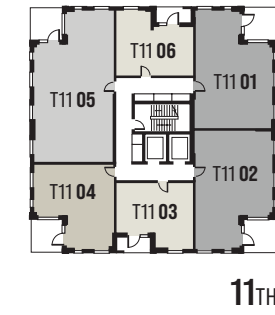
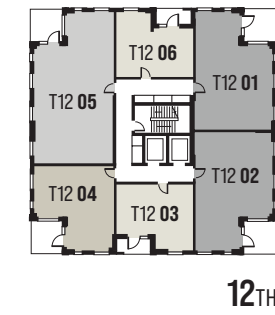
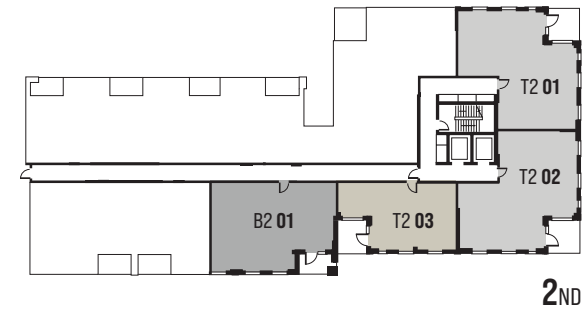



LEVEL 1

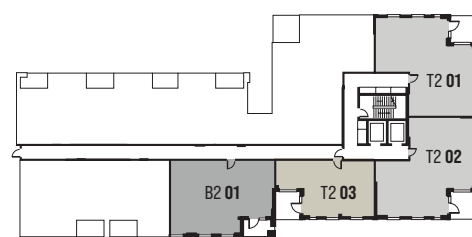

2

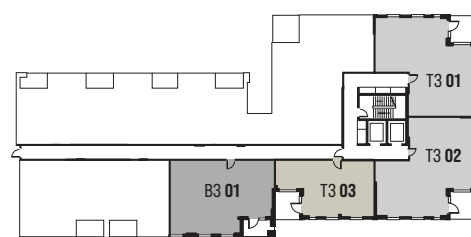

3

- Executive Suite
- 1 Bedroom
- 2 Bedroom
- 3 Bedroom

 B1 01 B2 01 B3 01	2 BEDROOM	91.8 SQ M	988 SQ FT
 T1 01 T2 01 T3 01	3 BEDROOM	99.1 SQ M	1067 SQ FT
 T1 02 T2 02 T3 02	3 BEDROOM	99.8 SQ M	1074 SQ FT
 T1 03 T2 03 T3 03	1 BEDROOM	62.2 SQ M	669 SQ FT

1-3

■ B4 01	2 BEDROOM	71.9 SQ M	774 SQ FT	■ B4 04	1 BEDROOM	51.4 SQ M	553 SQ FT
■ B4 02	2 BEDROOM	72.4 SQ M	779 SQ FT	■ B4 05	1 BEDROOM	51.4 SQ M	553 SQ FT
■ B4 03	2 BEDROOM	73.8 SQ M	794 SQ FT	■ B4 06	2 BEDROOM	81.4 SQ M	876 SQ FT



■	Executive Suite
■	1 Bedroom
■	2 Bedroom
■	3 Bedroom

■ T4 01	3 BEDROOM	99.6 SQ M	1072 SQ FT
■ T4 02	3 BEDROOM	100.1 SQ M	1077 SQ FT
■ T4 03	1 BEDROOM	62.0 SQ M	667 SQ FT
■ T4 04	3 BEDROOM	125.1 SQ M	1346 SQ FT

LEVEL 4

4

■ B5 01 B6 01 B7 01	2 BEDROOM	71.9 SQ M	774 SQ FT	■ B5 04 B6 04 B7 04	1 BEDROOM	51.4 SQ M	553 SQ FT
■ B5 02 B6 02 B7 02	2 BEDROOM	72.4 SQ M	779 SQ FT	■ B5 05 B6 05 B7 05	1 BEDROOM	51.4 SQ M	553 SQ FT
■ B5 03 B6 03 B7 03	2 BEDROOM	73.8 SQ M	794 SQ FT	■ B5 06 B6 06 B7 06	2 BEDROOM	81.4 SQ M	876 SQ FT

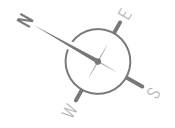

LEVEL 5

6

7

■	Executive Suite	■ T5 01 T6 01 T7 01	3 BEDROOM	99.6 SQ M	1072 SQ FT
■	1 Bedroom	■ T5 02 T6 02 T7 02	3 BEDROOM	100.1 SQ M	1077 SQ FT
■	2 Bedroom	■ T5 03 T6 03 T7 03	1 BEDROOM	62.0 SQ M	667 SQ FT
■	3 Bedroom	■ T5 04 T6 04 T7 04	3 BEDROOM	125.1 SQ M	1346 SQ FT

5-7

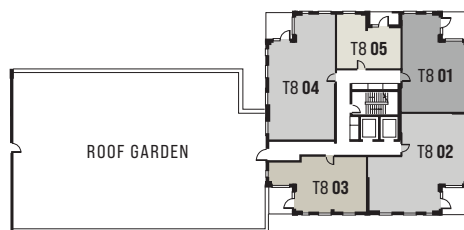
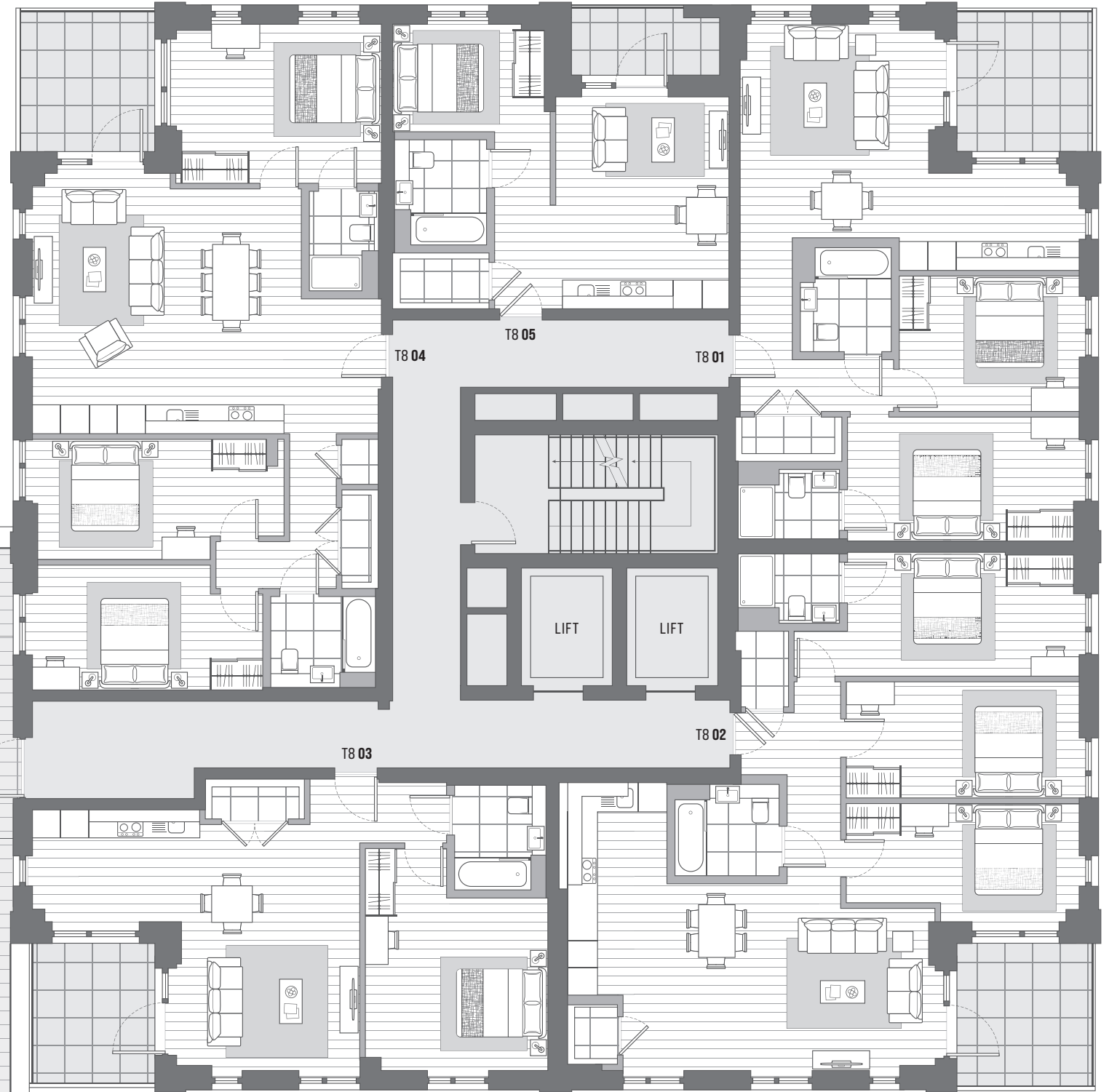
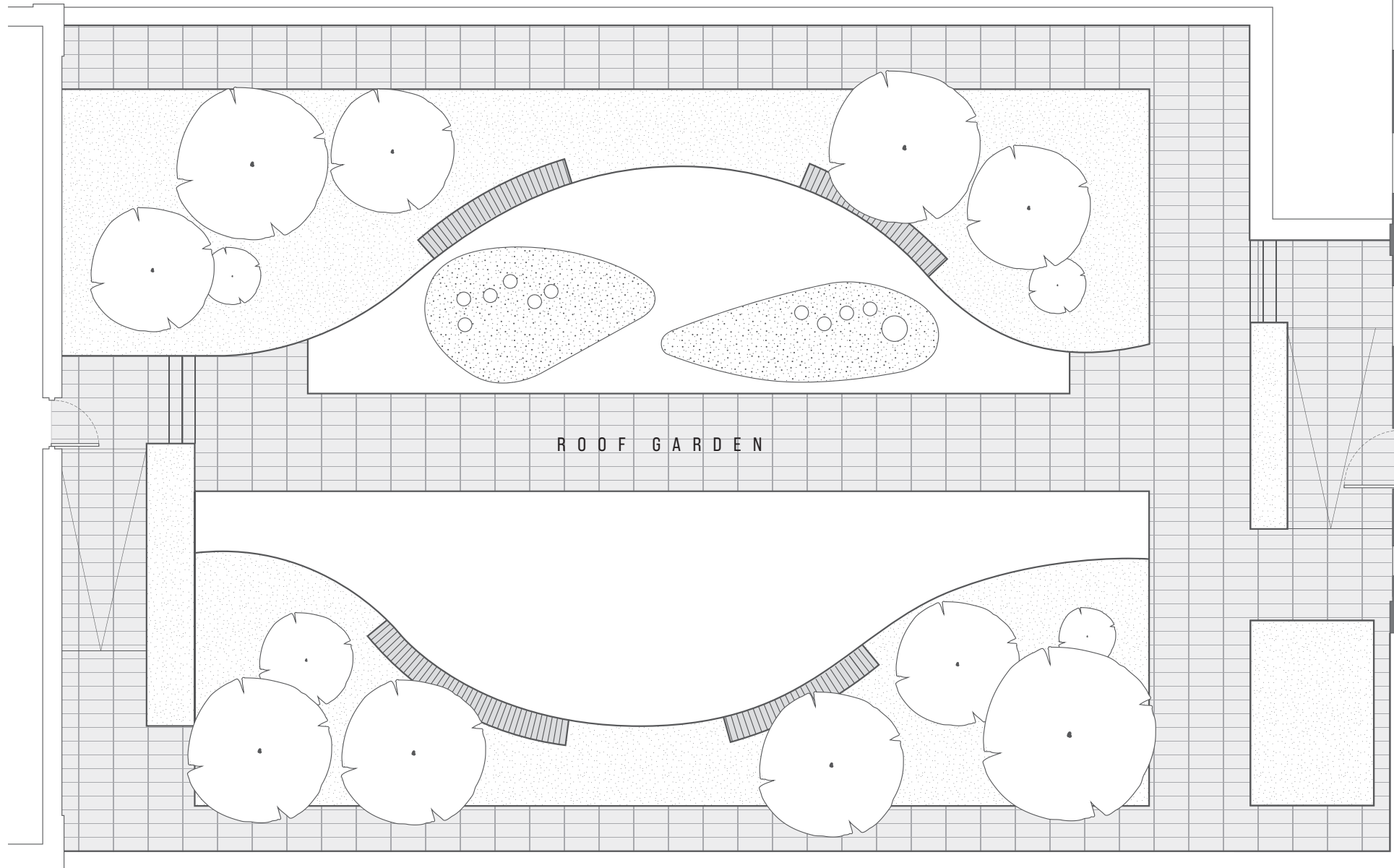

- Executive Suite
- 1 Bedroom
- 2 Bedroom
- 3 Bedroom

	T8 01	2 BEDROOM	74.1 SQ M	797 SQ FT
	T8 02	3 BEDROOM	99.8 SQ M	1074 SQ FT
	T8 03	1 BEDROOM	59.6 SQ M	641 SQ FT
	T8 04	3 BEDROOM	101.8 SQ M	1095 SQ FT
	T8 05	SUITE	40.1 SQ M	431 SQ FT

8

LEVEL 8

TOWER

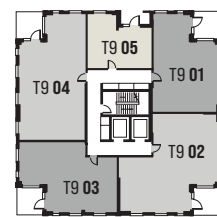
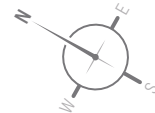
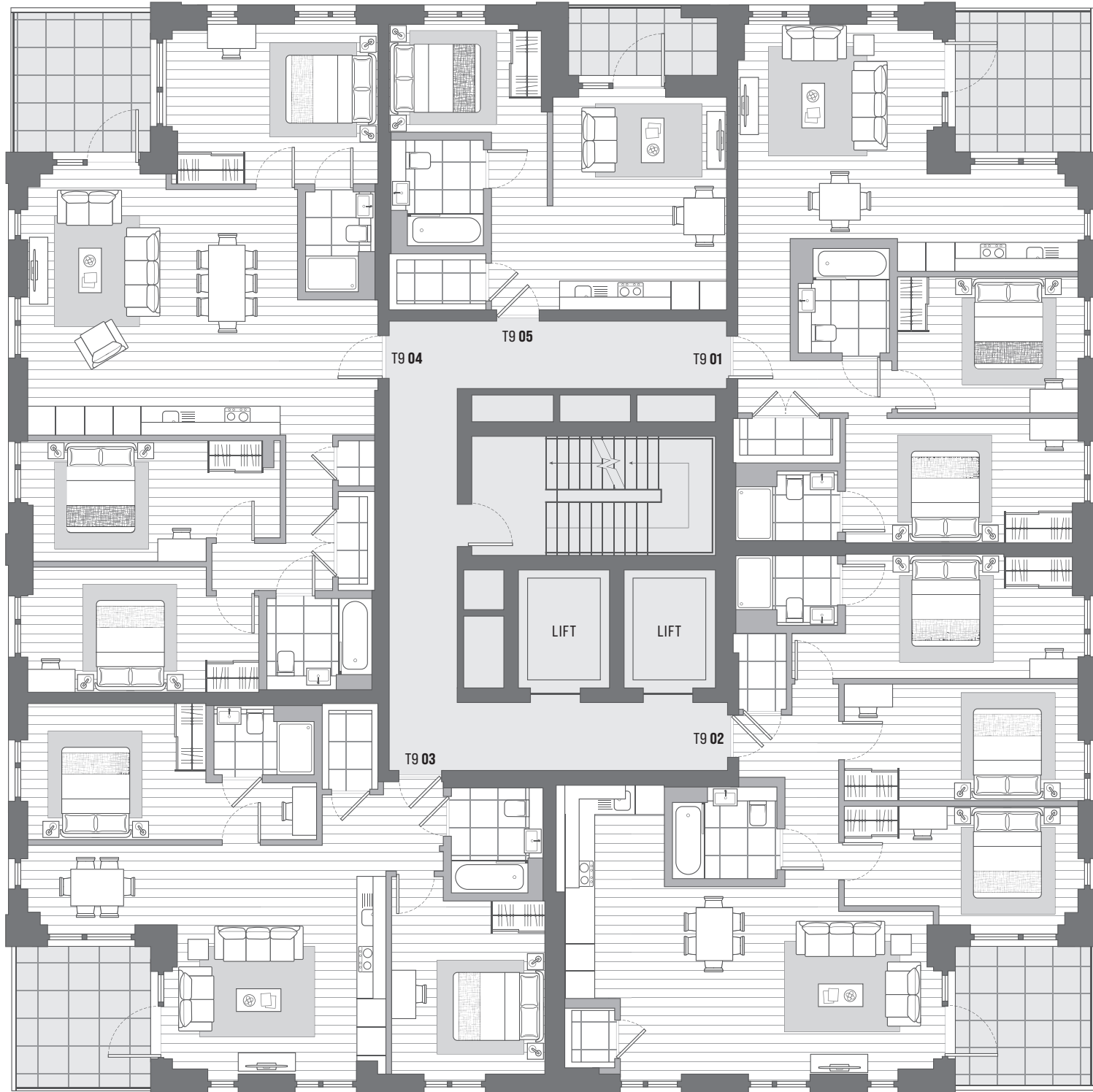

- Executive Suite
- 1 Bedroom
- 2 Bedroom
- 3 Bedroom

 T9 01	2 BEDROOM	74.1 SQ M	797 SQ FT
 T9 02	3 BEDROOM	99.8 SQ M	1074 SQ FT
 T9 03	2 BEDROOM	75.3 SQ M	810 SQ FT
 T9 04	3 BEDROOM	101.8 SQ M	1095 SQ FT
 T9 05	SUITE	40.1 SQ M	431 SQ FT

LEVEL 9

TOWER

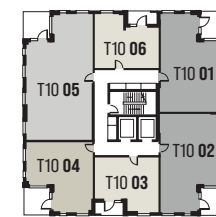
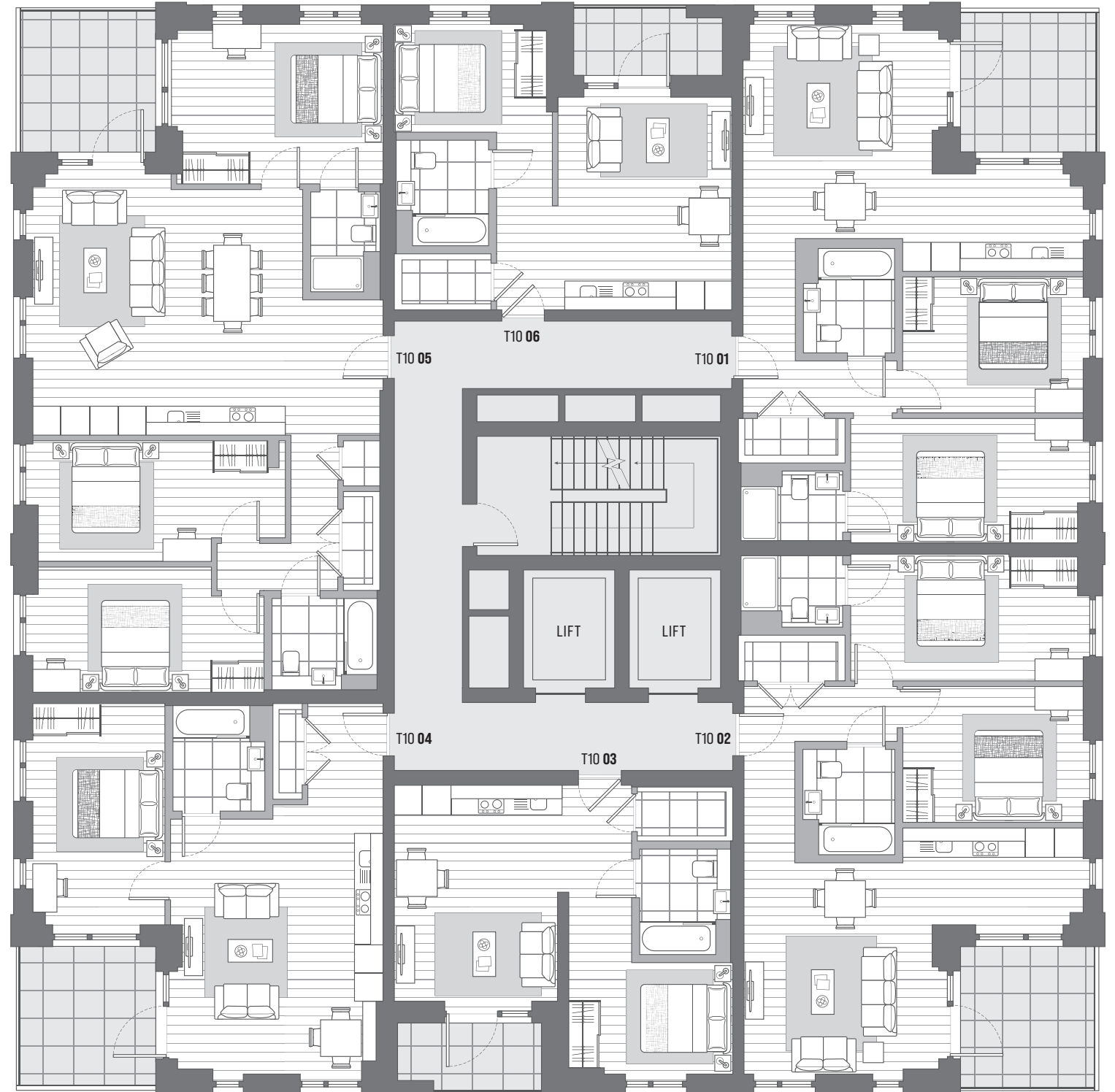

 T10 01	2 BEDROOM	74.1 SQ M	797 SQ FT
 T10 02	2 BEDROOM	74.4 SQ M	801 SQ FT
 T10 03	STUDIO	41.6 SQ M	447 SQ FT
 T10 04	1 BEDROOM	51.8 SQ M	557 SQ FT
 T10 05	3 BEDROOM	101.8 SQ M	1095 SQ FT
 T10 06	SUITE	40.1 SQ M	431 SQ FT

LEVEL 10

9-10

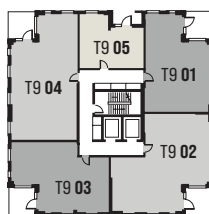
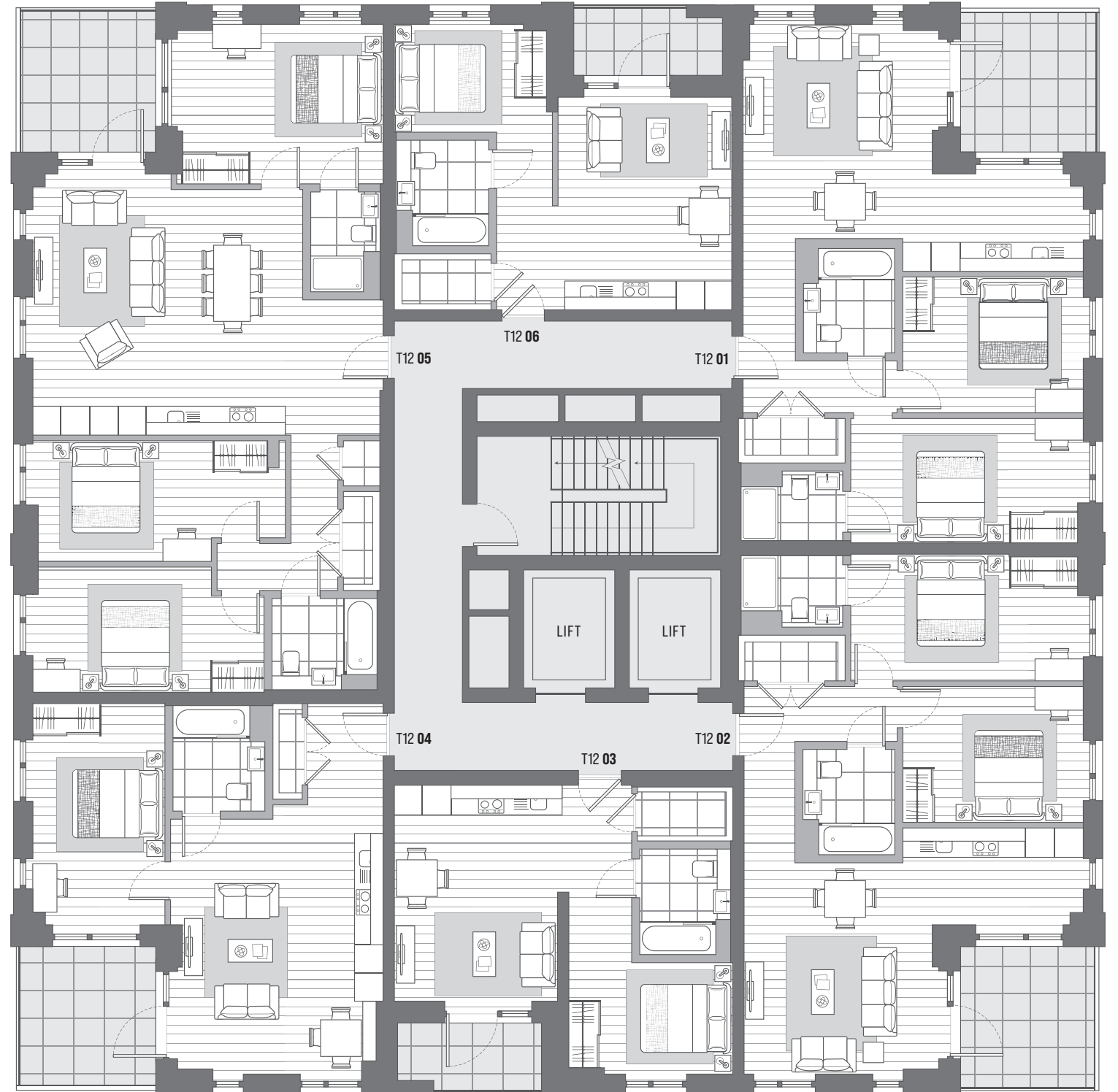
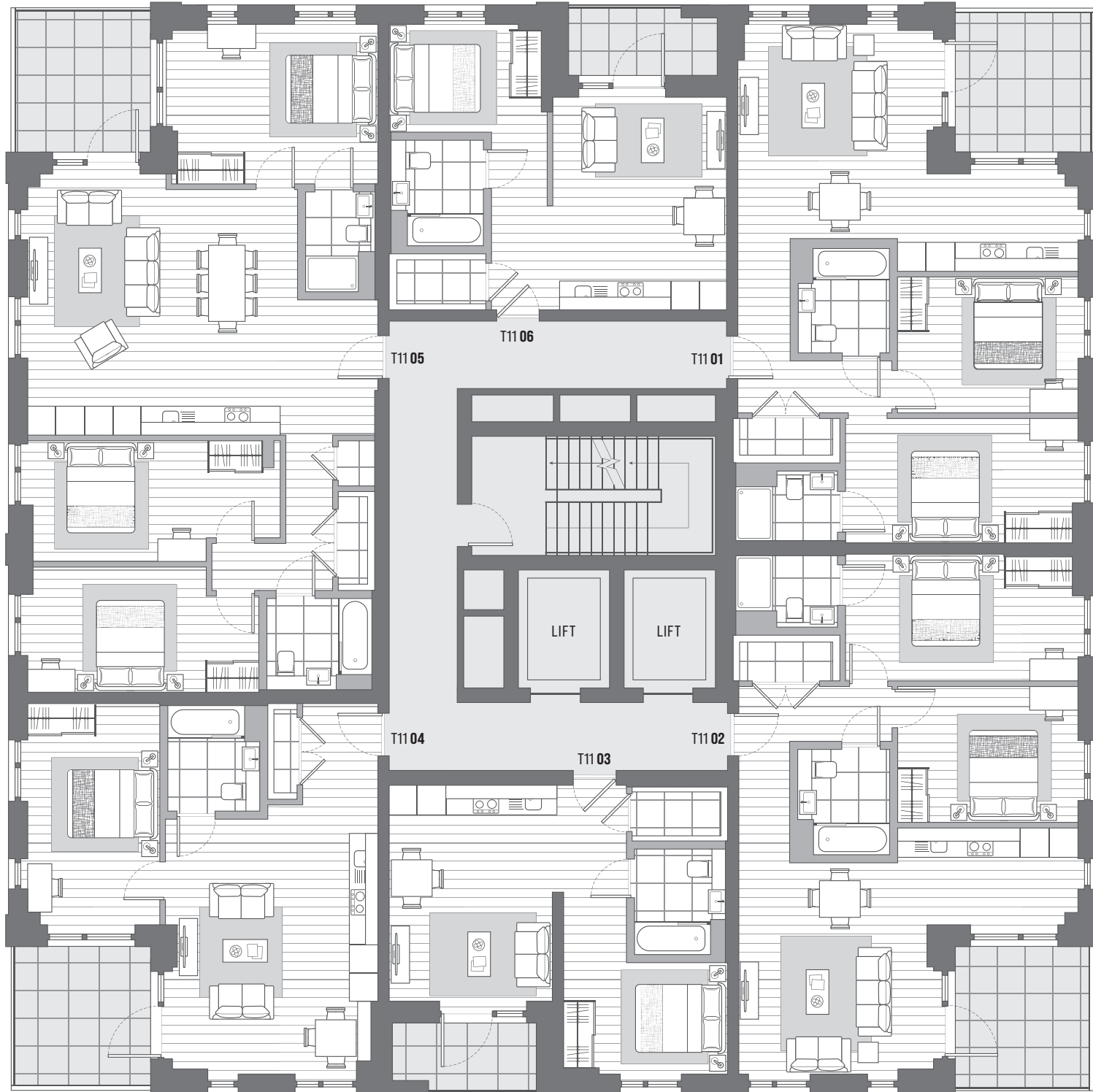

- Executive Suite
- 1 Bedroom
- 2 Bedroom
- 3 Bedroom

	T11 01	2 BEDROOM	74.1 SQ.M	797 SQ.FT
	T11 02	2 BEDROOM	74.4 SQ.M	801 SQ.FT
	T11 03	STUDIO	41.6 SQ.M	447 SQ.FT
	T11 04	1 BEDROOM	51.8 SQ.M	557 SQ.FT
	T11 05	3 BEDROOM	101.8 SQ.M	1095 SQ.FT
	T11 06	SUITE	40.1 SQ.M	431 SQ.FT

LEVEL 11

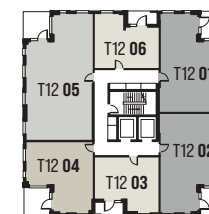

	T12 01	2 BEDROOM	74.1 SQ.M	797 SQ.FT
	T12 02	2 BEDROOM	74.4 SQ.M	801 SQ.FT
	T12 03	STUDIO	41.6 SQ.M	447 SQ.FT
	T12 04	1 BEDROOM	51.8 SQ.M	557 SQ.FT
	T12 05	3 BEDROOM	101.8 SQ.M	1095 SQ.FT
	T12 06	SUITE	40.1 SQ.M	431 SQ.FT

LEVEL 12

11-12



TOWER

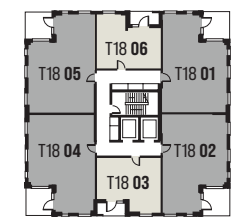

LEVEL 18

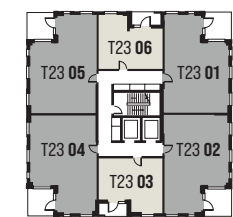

LEVEL 23

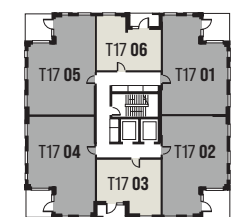

LEVEL 17

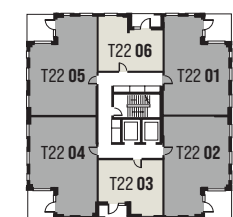

LEVEL 22

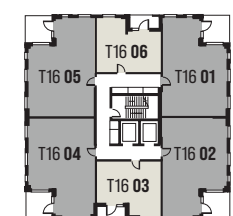

LEVEL 16

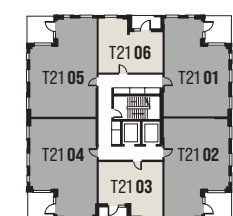

LEVEL 21

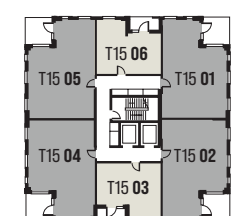

LEVEL 15

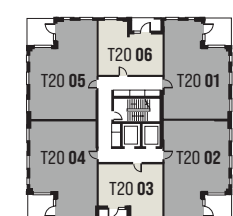

LEVEL 20

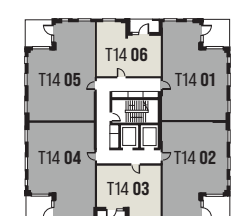

LEVEL 14

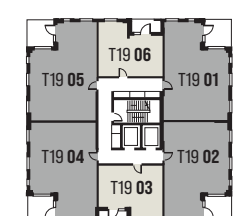

LEVEL 19

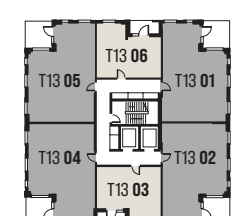

LEVEL 13

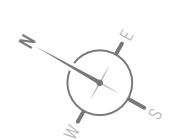

- Executive Suite
- 1 Bedroom
- 2 Bedroom
- 3 Bedroom

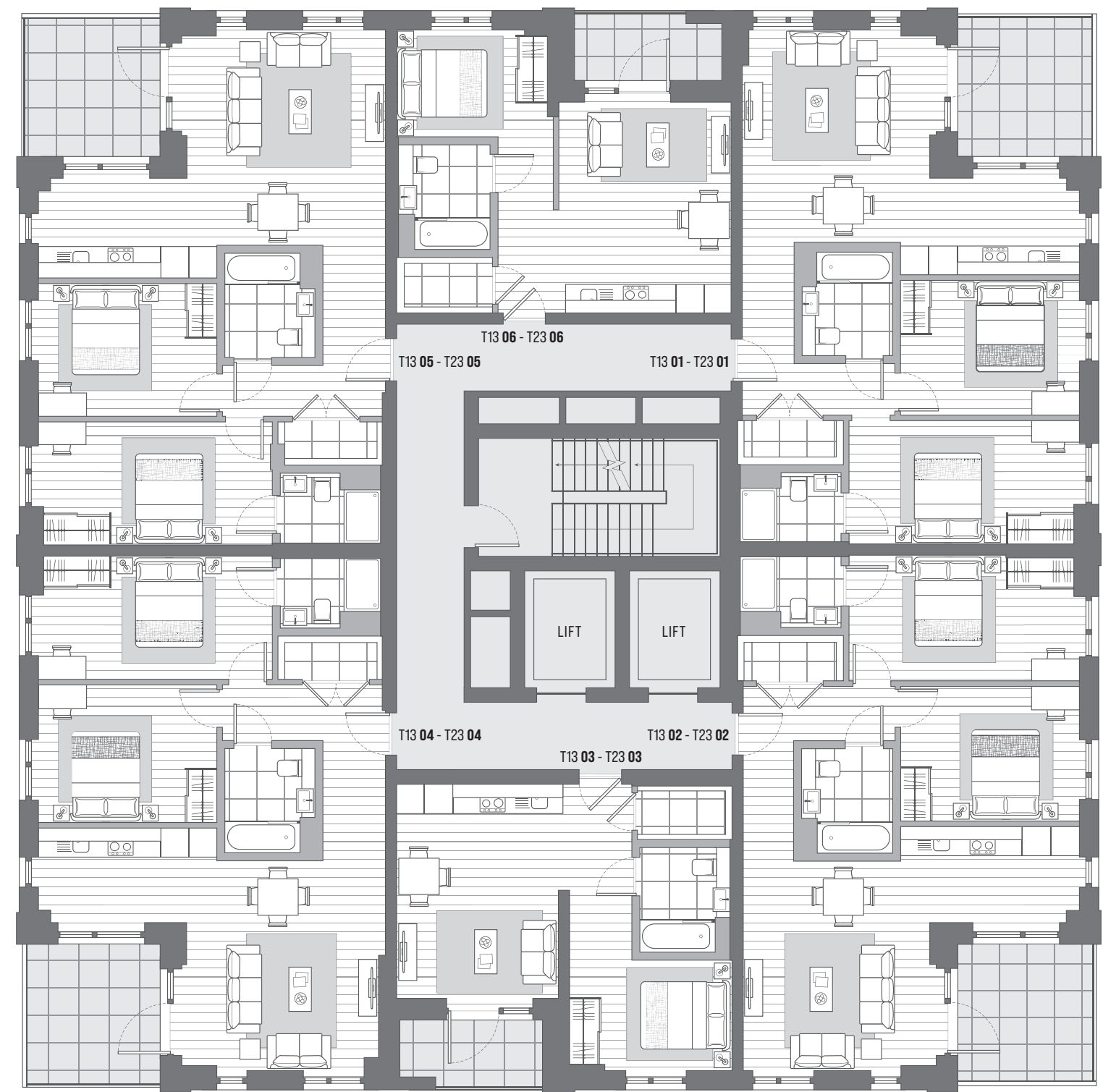

T13 01 - T23 01	2 BEDROOM	74.1 SQ M	797 SQ FT
T13 02 - T23 02	2 BEDROOM	74.4 SQ M	801 SQ FT
T13 03 - T23 03	STUDIO	41.6 SQ M	447 SQ FT
T13 04 - T23 04	2 BEDROOM	76.4 SQ M	822 SQ FT
T13 05 - T23 05	2 BEDROOM	76.9 SQ M	827 SQ FT
T13 06 - T23 06	SUITE	40.1 SQ M	431 SQ FT

13-23

Block floor plans and apartment layouts are intended to be correct, precise details may vary. Total areas are accurate to within 5%.



T24 02
Example render showing furniture
and floor finishings.

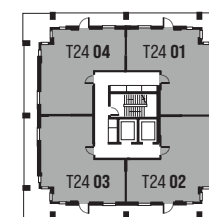
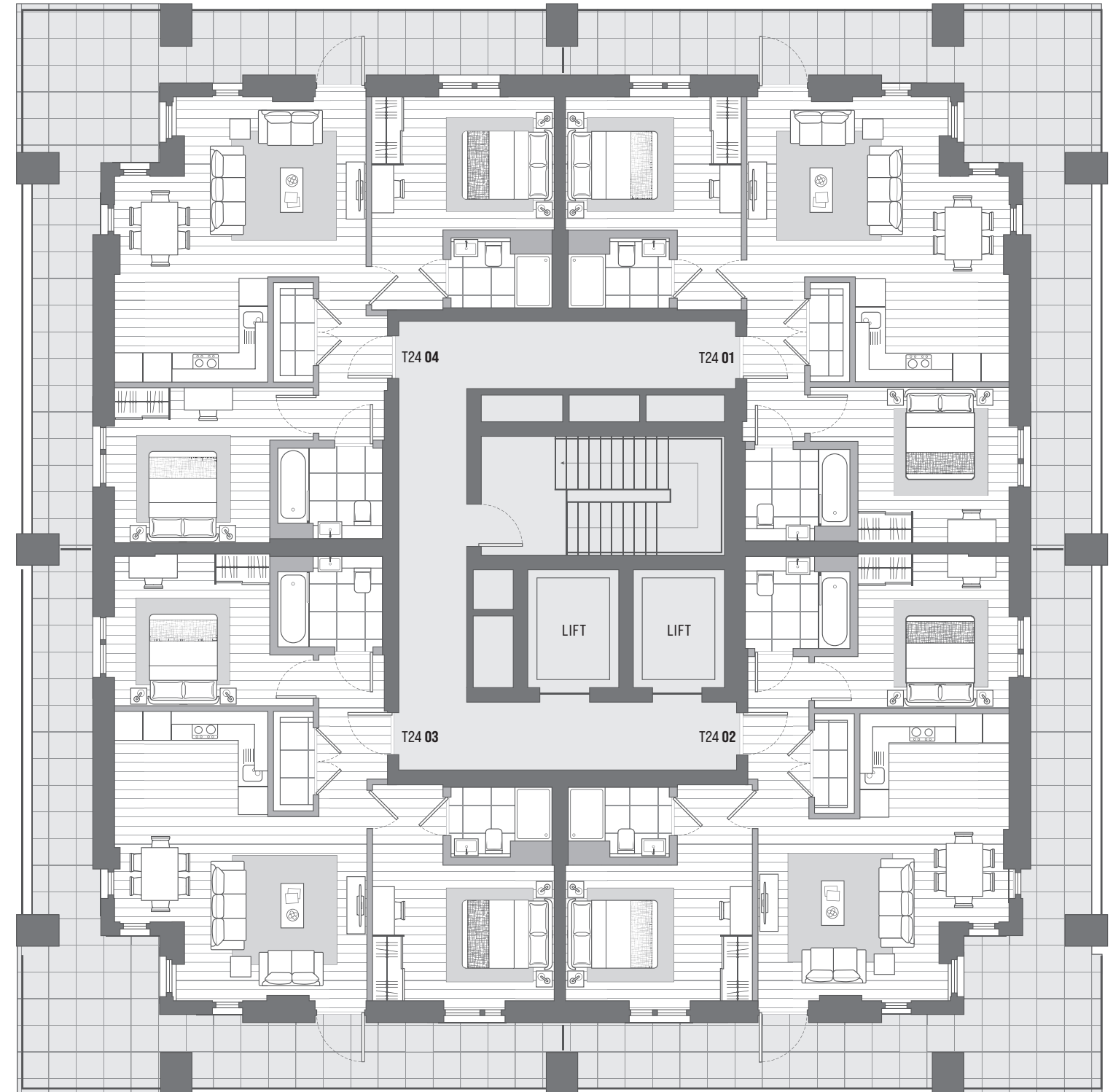

T24 01	2 BEDROOM	72.6 SQ M	781 SQ FT
T24 02	2 BEDROOM	73.3 SQ M	789 SQ FT
T24 03	2 BEDROOM	74.5 SQ M	802 SQ FT
T24 04	2 BEDROOM	73.1 SQ M	787 SQ FT

LEVEL 12

Block floor plans and apartment layouts are intended to be correct, precise details may vary. Total areas are accurate to within 5%.

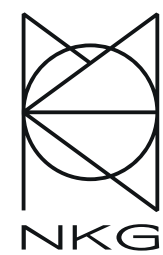

The height of luxury

EXCLUSIVELY FROM CITY & DOCKLANDS

24

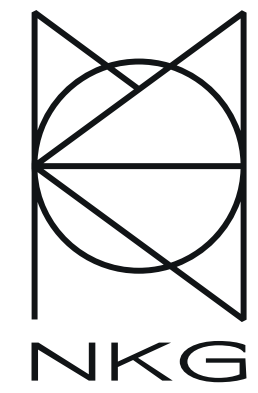
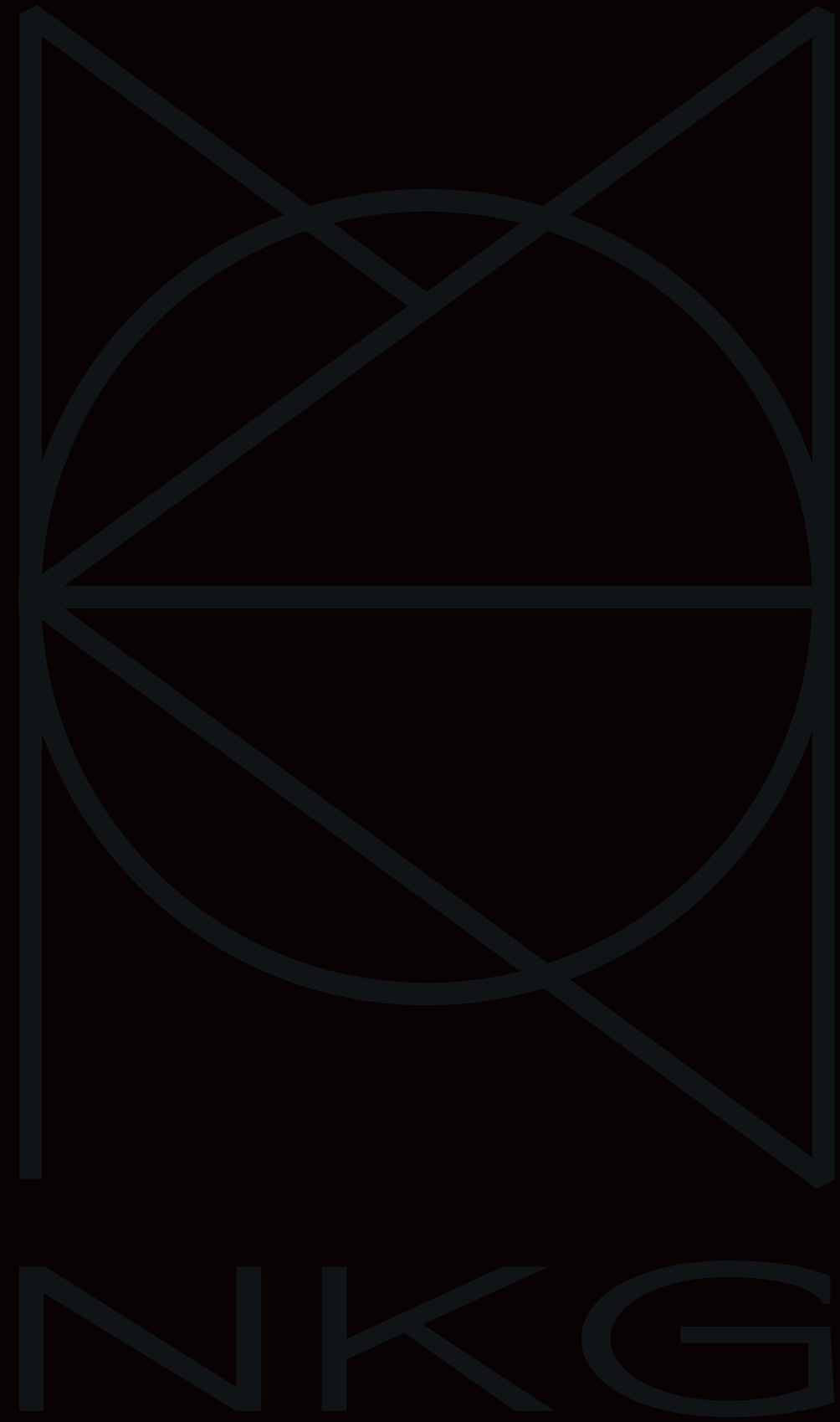

SHOWCASING THE GATEWAY
TO THE
OPDC OLD OAK ENTERPRISE ZONE

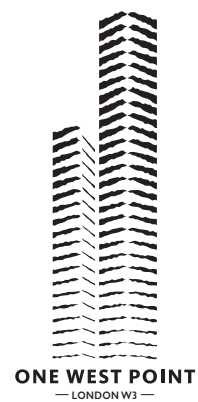

701 APARTMENTS COMPRISING PRIVATE,
AFFORDABLE AND BUILD TO RENT



Mitre Yard

241 HOMES DESIGNED FOR CITY & DOCKLANDS
PRS MANAGEMENT



248 APARTMENTS COMPRISING
PRIVATE, AFFORDABLE AND LONDON LIVING RENT

City & Docklands -
delivering over
1,100 new apartments
within the largest
regeneration masterplan
in the UK

City & Docklands
www.cityanddocklands.com

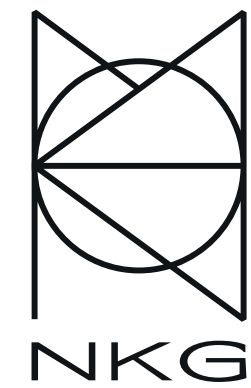

For further information and sales enquiries
e: sales@cityanddocklands.com

A MAJOR NEW DEVELOPMENT BY

City  Docklands

Disclaimer September 2021. These particulars are compiled with care to give a fair description but we cannot guarantee their accuracy and they do not constitute an offer or contract. City & Docklands Property Group reserve the right to alter any specifications and floor plan layouts without prior notice. All journey and walking times stated are approximate, source tfl.gov.uk, crossrail.co.uk and google.co.uk. Walking times and distances between NKG and Old Oak Common transport hub are projected but may differ when Public Highways/OPDC determine public right of way and pedestrian routing between site and subject station. Interior and exterior images are computer generated and are shown for illustrative purposes. All resident facilities and amenities shown within this brochure are planned/intended but are subject to change or modification during the build programme. Potential purchasers should satisfy themselves as to the actual view any given apartment may provide. New Kensington Gate is a preferred marketing name only.

